

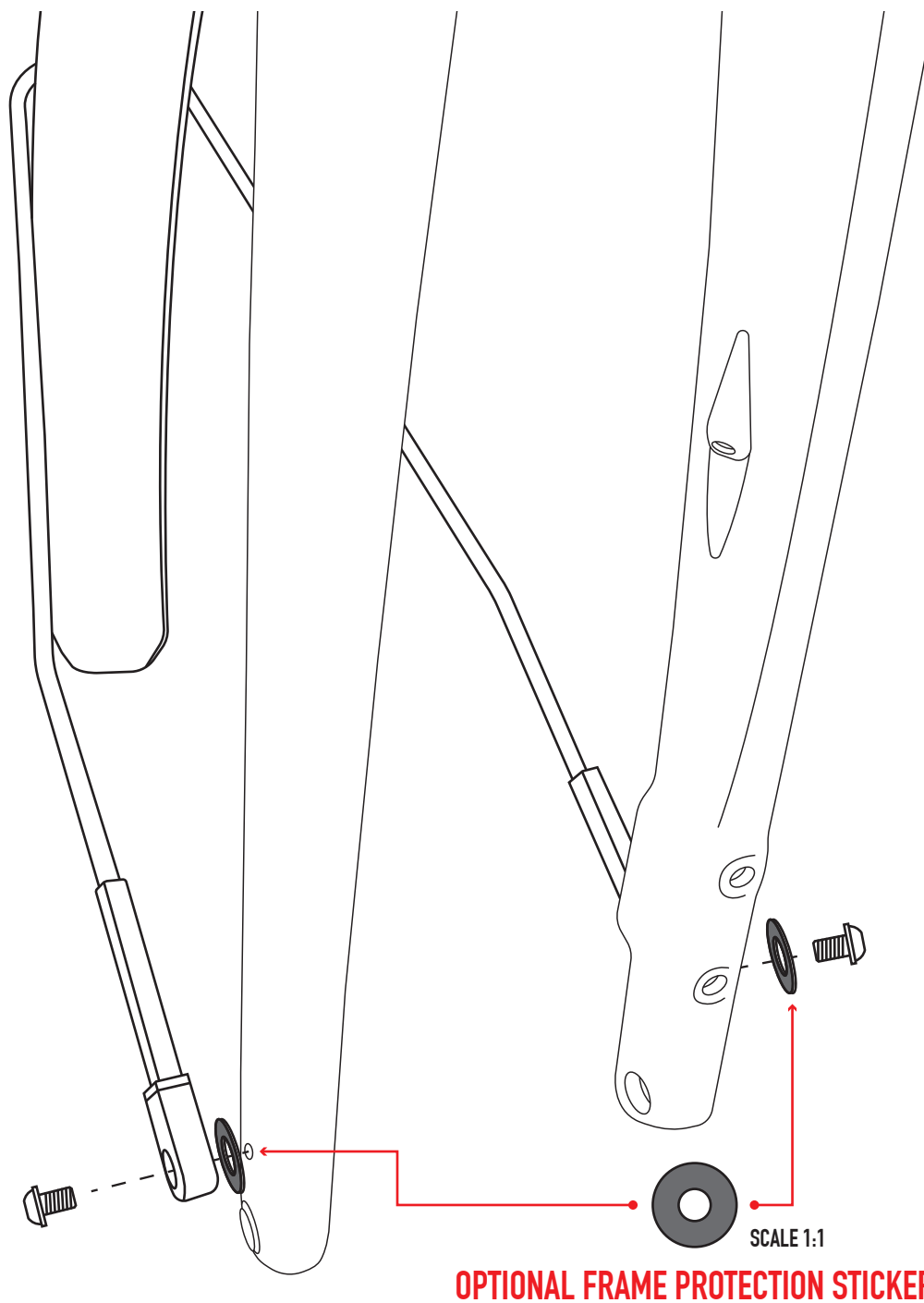

## FENDER MOUNT KIT – FRONT

Fender Requirements: Front fender fork crown mount must use bolts rather than rivets.

Start by attaching the lower front fender arms directly to the lower mounts above the fork dropouts. Use the provided hardware and any washers needed to properly space the fender for proper clearance.





# FENDER MOUNT KIT – FRONT

Use the stand-off spacer for front fender mount under the fork. Use a combination of washer or spacers to achieve the right clearance for your frame and wheel/tire.

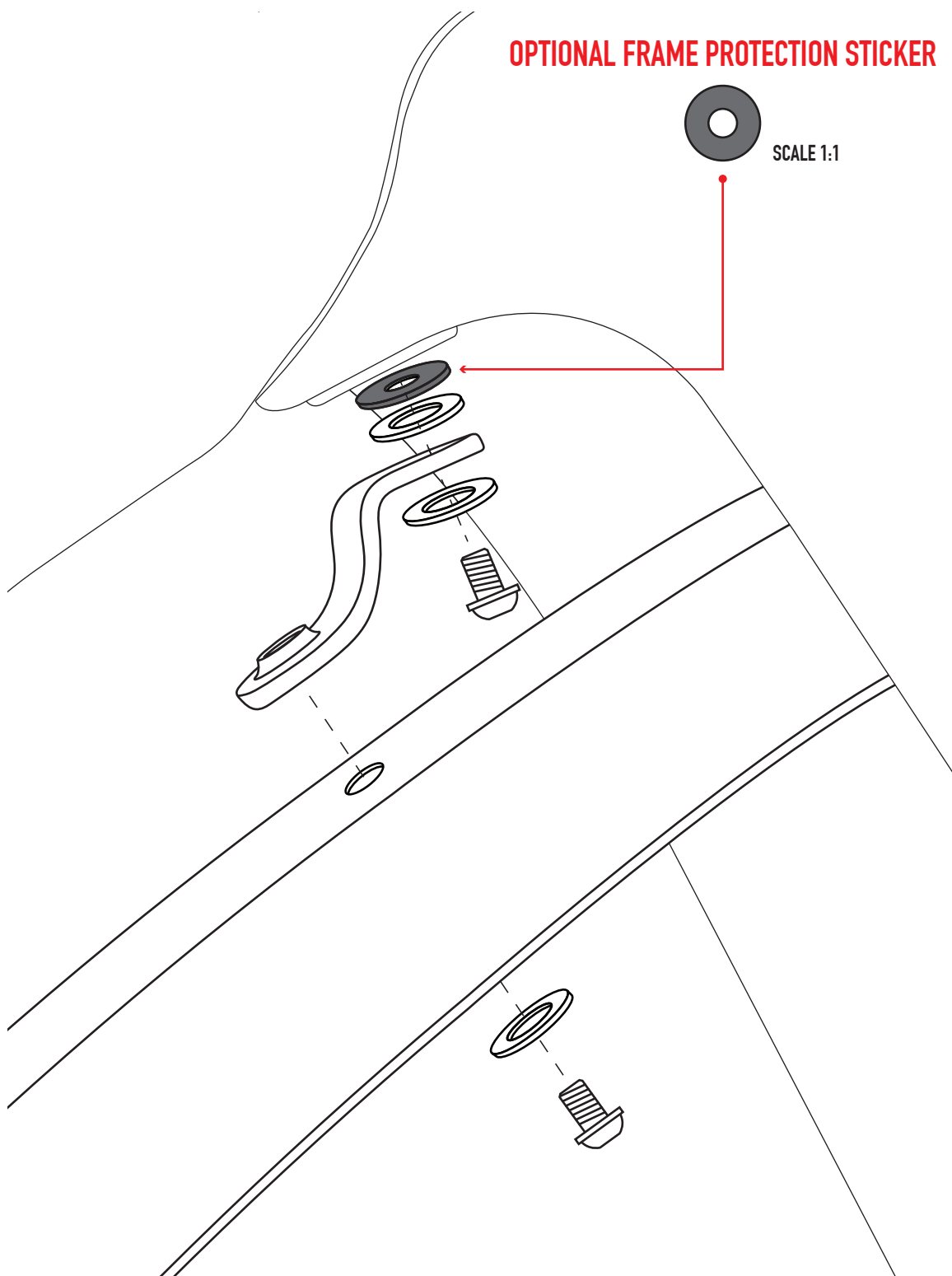



## FENDER MOUNT KIT - REAR

Use a combination of washer or spacers to achieve the right clearance for your frame and tire/wheel at the bottom bracket mounting location.

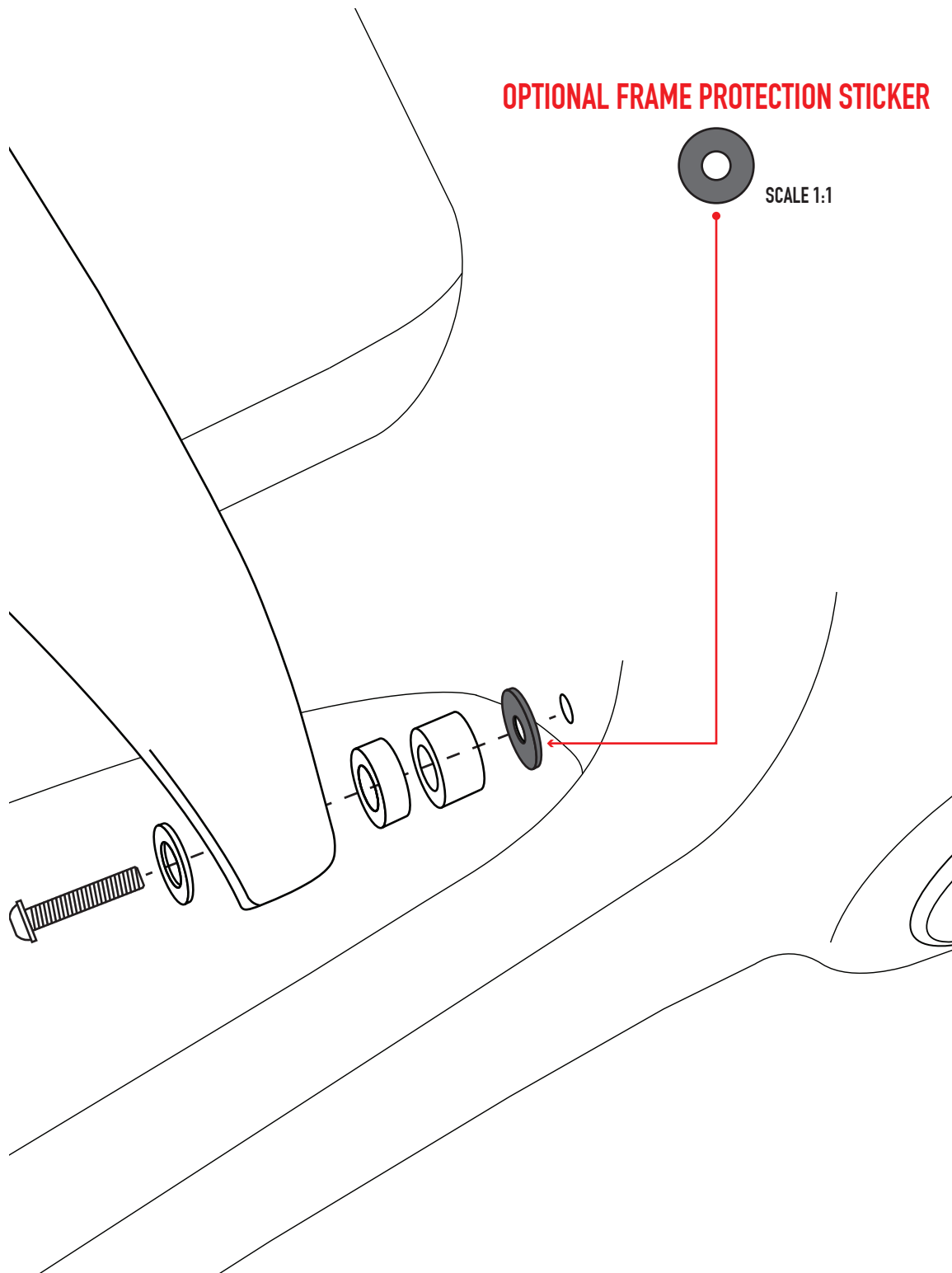



## FENDER MOUNT KIT - REAR

Use the eyelet bolts at the rear drop-out mounts. Use a combination of washer or spacers to achieve the right clearance for your frame and tire/wheel at this location.

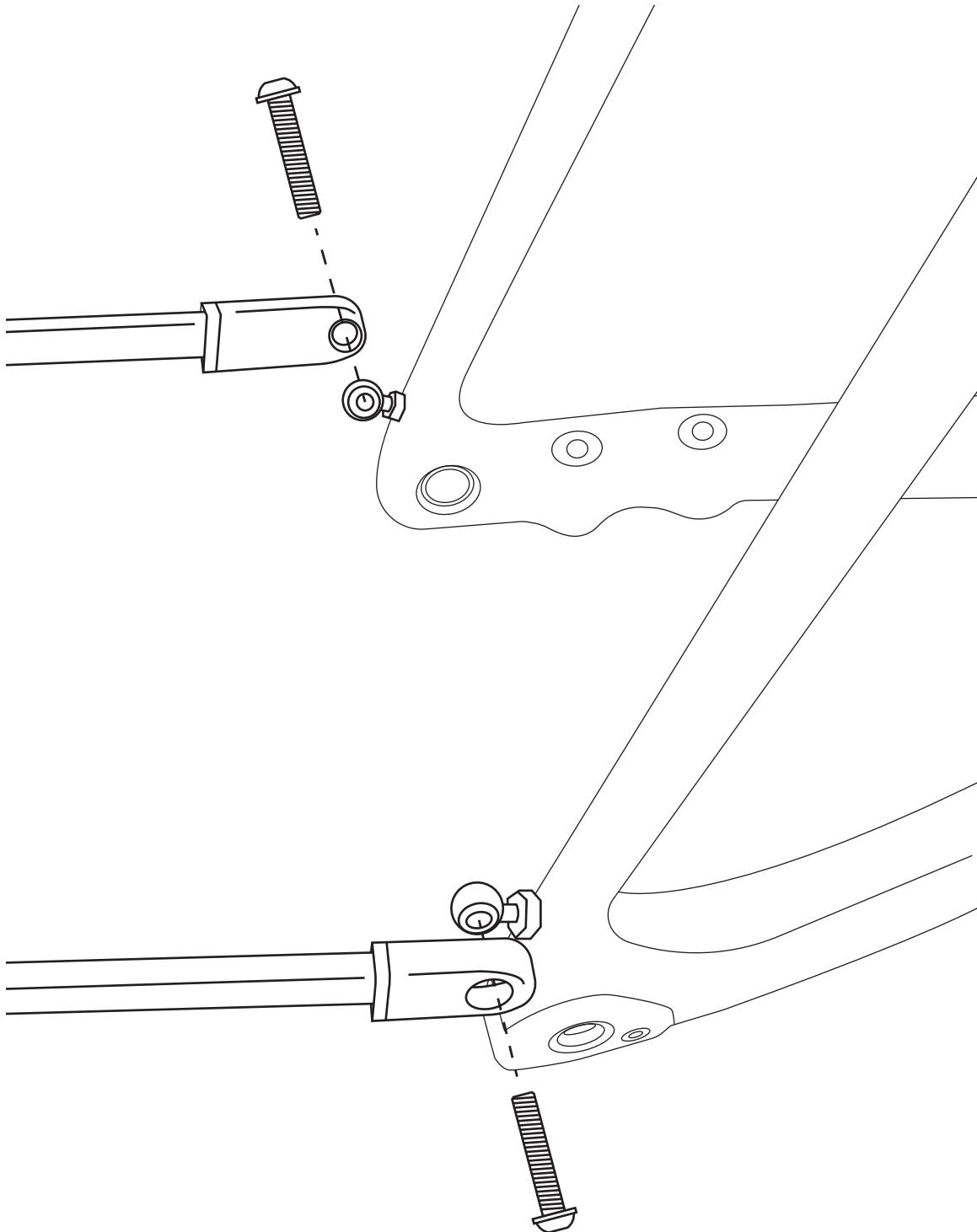



## FENDER MOUNT KIT - REAR

Frame protection stickers are provided for extra frame protection under this mount. Place the upper bridge fender mount using the rubber mounting bands to give proper clearance for your wheel/tire. Use a combination of spacers and washers provided to achieve the correct clearance for your wheel/tire combination.

### OPTIONAL FRAME PROTECTION STICKER

