

Adventure Fork Installation Instructions

Tools Needed:

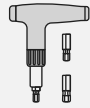

4, 5, 6mm Adjustable
Torque Wrench,

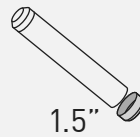

1.5"

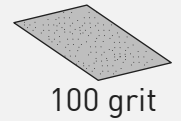
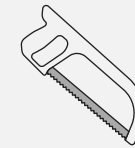
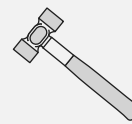

100 grit

1.

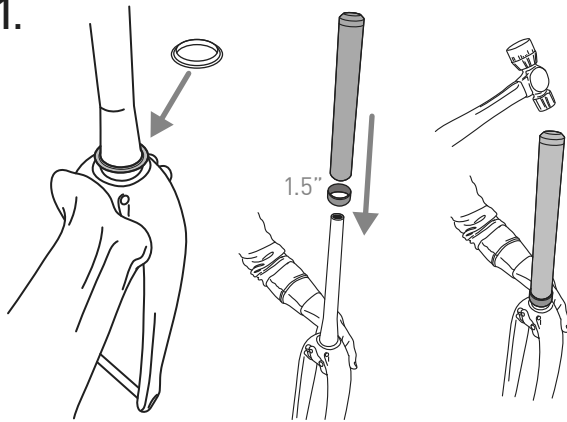

2.

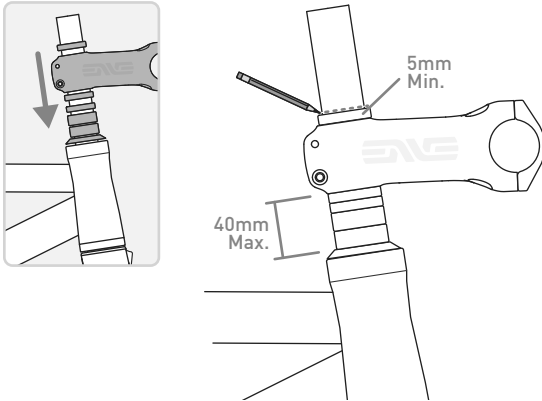

3.

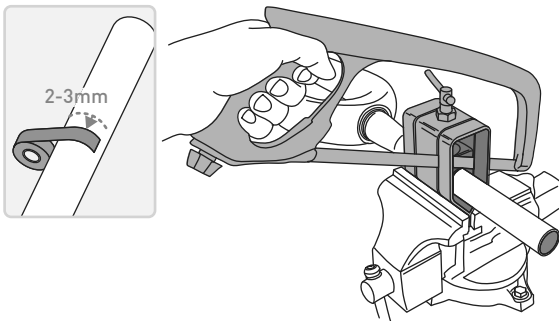

4.

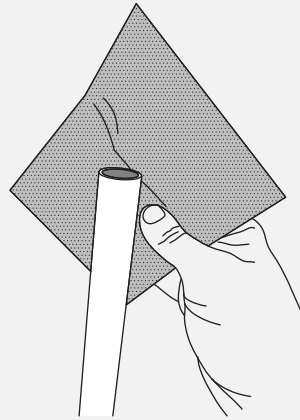

5.

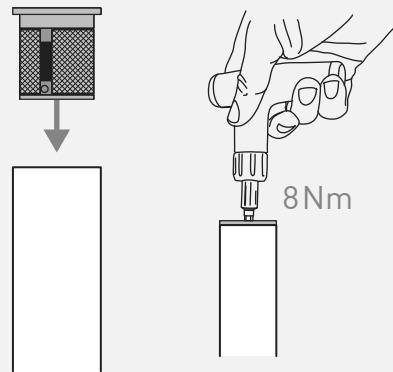

6.

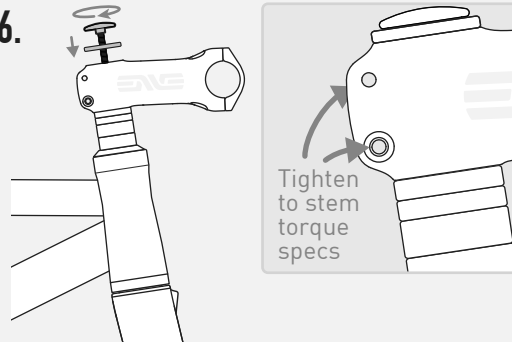

7.

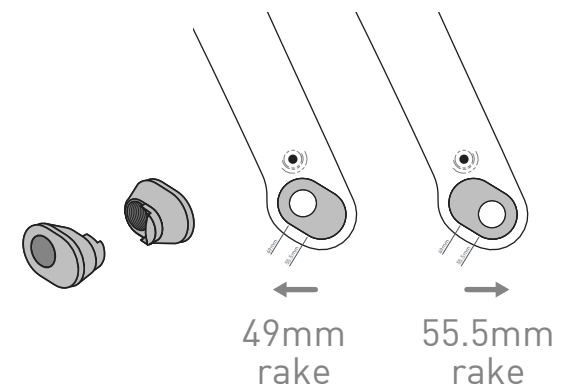

8.

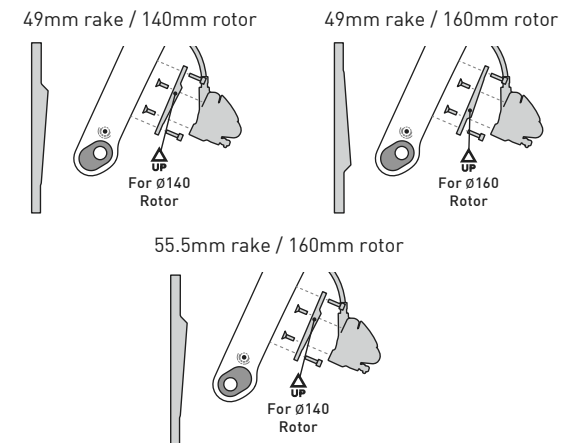

9.

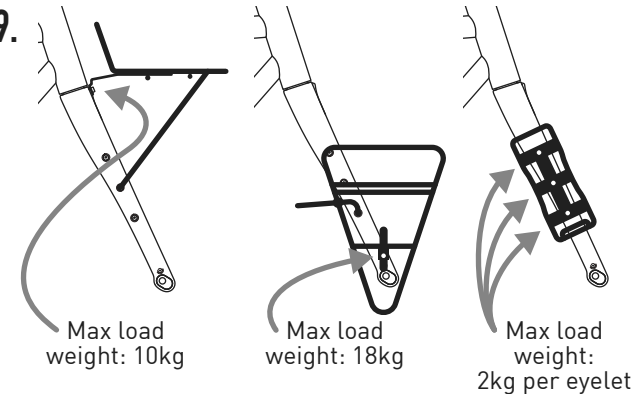

Adventure Fork + Dynamo Hub Routing Instructions

1. Dynamo hub routing for light only

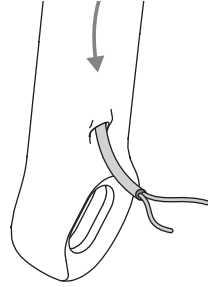
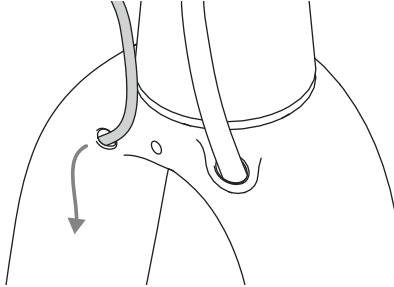

2. Dynamo hub routing for USB topcap only

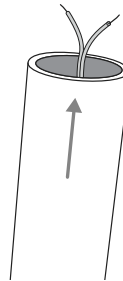
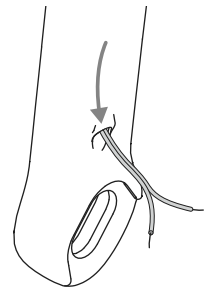
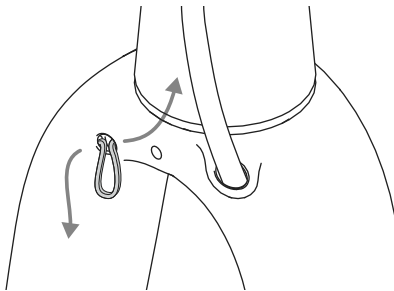

3. Dynamo hub routing for light & USB topcap

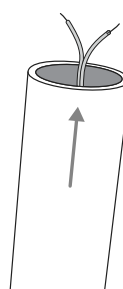
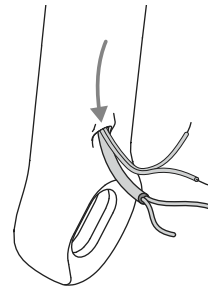
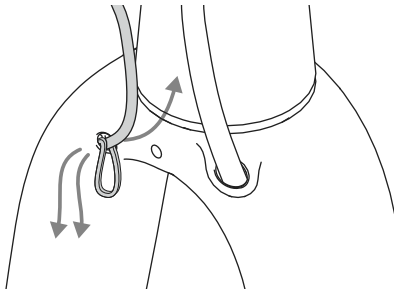

**ENVE Adventure Fork
Installation Instructions**

ENVE Composites, LLC
Ogden, UT 84401, USA